

# COMMERCIAL SPACE LEASE OPPORTUNITY

1051 Greenmount Avenue



## ABOUT THE PROPERTY

ReBUILD Metro is pleased to present a lease opportunity for a turn-key commercial space located in the heart of the catalytic Johnston Square neighborhood.

Located at the intersection of Greenmount Avenue and E. Chase Street, 1051 Greenmount Ave is in the footprint of a \$200 million reinvestment area bringing in 109 new apartments, a library, and a new park.

ReBUILD Metro is the recipient of a State Grant that would assist in the funding of the build out of the tenant's space, allowing for a spec build out.

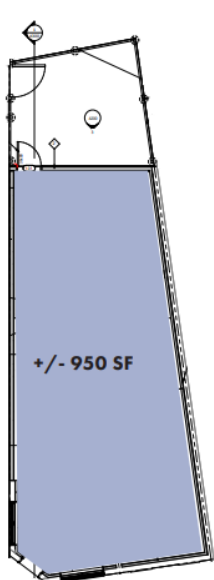

First floor

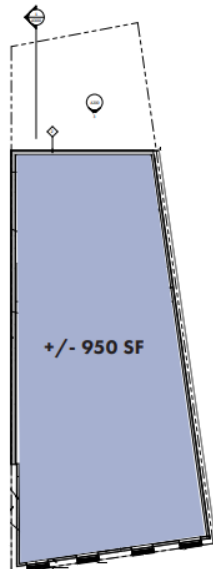

Second floor

## KEY FEATURES

- +/- 1800 SF across two floors
- Corner property with street facing storefront
- C-1 Zoning
- Bare shell allowing for full built-to-suit opportunity for tenant
- Adjacent vacant lots available as opportunity for additional leasable space
- Funding available for tenant fit-out through landlord
- Rent concessions for first year of lease to support emerging businesses
- Landlord covers soft cost associated to build out of space

## CONTACT US

410-563-6220

[devtconst@rebuildmetro.com](mailto:devtconst@rebuildmetro.com)



[rebuildmetro.com](http://rebuildmetro.com)